

REASONING MAINS GENIUS



EXAM
Genius

**SOLVE
NOW**



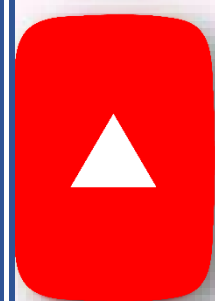

EXAM GENIUS

ACE YOUR EXAM WITH EXAM GENIUS



Daily Current Affairs Pdf

01

Mains Reasoning Practice Pdf

02

Weekly current Affairs Pdf

03

Daily Current Affairs Quiz

04

Daily speed booster for quant

05

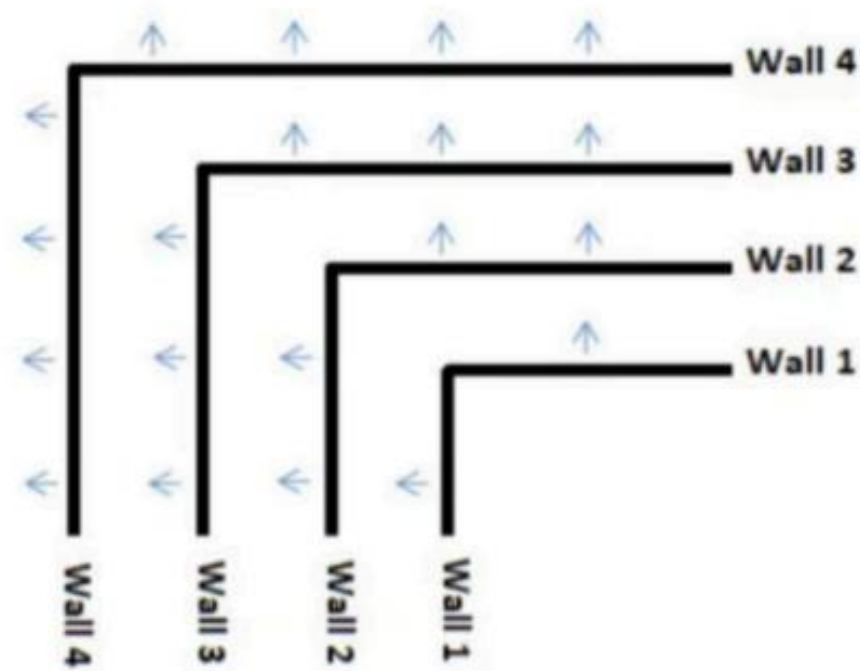

TABLE OF CONTENTS

01	Mains Puzzle 01	>
02	Mains Puzzle 02	>
03	Mains Puzzle 03	>
04	Alpha-numeric-series	>
05	Direction Sense	>

PUZZLE 01

Four walls were there in a field and twenty persons were standing adjacent to them as given below in the figure. In the context of each wall, an equal number of persons face towards the north and west directions. Arrow marks provided in the diagram indicate the persons standing in front of or behind each other in line. Further information regarding this is given below: Note: Person A was standing to the left/right of person B means they were standing adjacent to the same wall number. Person A was standing in front of or behind person B means they were standing adjacent to different walls and facing the same direction.



Tahir who was standing immediate right of Gauri was having Qasim standing behind him. Varun who was standing behind Punit was having Ritu immediate to his right. Sahil was standing behind Kunal. Manish was standing fifth to the left of Urmi. Rahul was facing towards the north direction. Dipak was standing to the right of Manik. Indra was standing immediate left of Qasim adjacent to the same wall. Kunal was standing second to the right of Zahir. Soumi was standing second to the left of Ritam. Gita and Ritam were standing adjacent to the same wall.



Yami was standing third to the right of Punit and they were facing in the same direction. Zahir and Ritu were facing in the west direction. Nayan and Sahil were standing adjacent to the same wall.

एक मैदान में चार दीवारें थीं और बीस व्यक्ति उनके बगल में खड़े थे जैसा कि नीचे चित्र में दिखाया गया है। प्रत्येक दीवार के संदर्भ में, समान संख्या में व्यक्ति उत्तर और पश्चिम दिशा की ओर मुँह करके खड़े हैं। आरेख में दिए गए तीर के निशान पंक्ति में एक दूसरे के सामने या पीछे खड़े व्यक्तियों को दर्शाते हैं। इसके बारे में आगे की जानकारी नीचे दी गई है: नोट: व्यक्ति A, व्यक्ति B के बाएँ/दाएँ खड़ा था इसका मतलब है कि वे एक ही दीवार संख्या के बगल में खड़े थे। व्यक्ति A, व्यक्ति B के सामने या पीछे खड़ा था इसका मतलब है कि वे अलग-अलग दीवारों के बगल में खड़े थे और एक ही दिशा का सामना कर रहे थे।

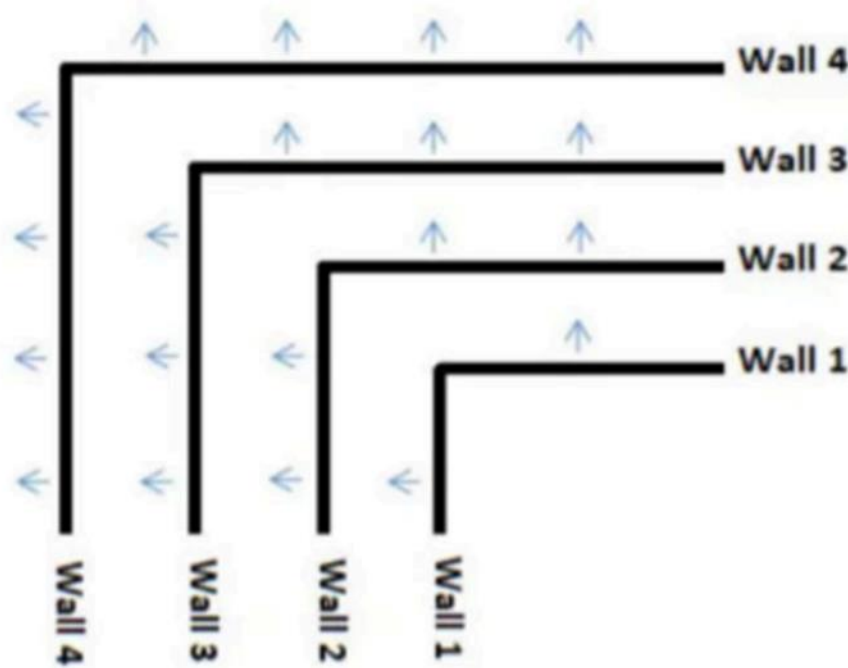

ताहिर जो गौरी के ठीक दाईं ओर खड़ा था, उसके पीछे कासिम खड़ा था। वरुण जो पुनीत के पीछे खड़ा था, उसके ठीक दाईं ओर रितु थी। साहिल कुणाल के पीछे खड़ा था। मनीष उर्मि के बाईं ओर पाँचवें स्थान पर खड़ा था। राहुल उत्तर दिशा के सम्मुख था। दीपक माणिक के दाईं ओर खड़ा था। इंद्र उसी दीवार से सटे कासिम के बाईं ओर खड़ा था। कुणाल ज़हीर के दाईं ओर दूसरे स्थान पर खड़ा था। सौमी रीतम के बाईं ओर दूसरे स्थान पर खड़ी थी।

गीता और रीतम एक ही दीवार से सटे खड़े थे। यमी पुनीत के दाईं ओर तीसरे स्थान पर खड़ी थी और वे एक ही दिशा के सम्मुख थे। ज़हीर और रितु पश्चिम दिशा के सम्मुख थे। नयन और साहिल एक ही दीवार से सटे खड़े थे।



PUZZLE 02

Ten persons – A, C, G, H, K, P, R, T, U and Y were born in different years. The age of each person is calculated from the base year 2023. Age of each person is not less than 7 years and not more than 75 years. No two persons have the same age. A was born in 1969. The difference between the ages of R and A is 19 years. The difference between the ages of R and H is 27 years. No one was born between H and P. Two years gap between the years in which H and P were born. U was born eighteen years before P. P was born in neither 1958 nor 1980. The difference between the ages of G and U is 17 years. K was born two years before G. K's age is not less than 45 years. The sum of the ages of K and T is 91 years. The average age of T and C is 52 years. The difference between the ages of C and Y is 13 years.

दस व्यक्ति - A, C, G, H, K, P, R, T, U और Y विभिन्न वर्षों में पैदा हुए थे। प्रत्येक व्यक्ति की आयु की गणना आधार वर्ष 2023 से की जाती है। प्रत्येक व्यक्ति की आयु 7 वर्ष से कम नहीं और 75 वर्ष से अधिक नहीं है। दो व्यक्तियों की आयु समान नहीं है। A का जन्म 1969 में हुआ था। R और A की आयु के बीच का अंतर 19 वर्ष है। R और H की आयु के बीच का अंतर 27 वर्ष है। H और P के बीच कोई भी पैदा नहीं हुआ था। जिन वर्षों में H और P का जन्म हुआ था, उनके बीच दो साल का अंतर है। U का जन्म P से अठारह साल पहले हुआ था। P का जन्म न तो 1958 में हुआ था और न ही 1980 में। G और U की आयु के बीच का अंतर 17 वर्ष है। K का जन्म G से दो साल पहले हुआ था। K की आयु 45 वर्ष से कम नहीं है



PUZZLE 03

For the recruitment of eight different subject teachers in a district, document verification was arranged in a square shaped room by the education department. Two chairs were kept on each side of the room Facing towards the centre. On each chair, one person was sitting who was doing document verification For only one subject. Eight CCTV cameras were placed in the middle of the room facing towards the chairs i.e. one CCTV was observing only one chair where document verification was carried out. Each CCTV was marked in 1 to 8. Each CCTV was monitored by a person, i.e. eight different persons of the education department were monitoring for transparency in the process.

Preet was monitoring with camera numbered 4 to the Chemistry subject teachers. Camera number 5 which was monitoring the person verifying Economics subject teachers, facing towards the west. The person who was verifying History subject teacher was facing towards the north. The person doing verification for Science subject teachers was not on the same side which is faced by camera numbered 3. Manoj was monitoring English subject teachers verification with the highest numbered camera. The camera which was monitoring the verification for Hindi subject teachers was placed to the immediate left of the smallest numbered camera. Three cameras were placed between camera number 6 and camera number 7. Pawan was monitoring Physics subject teachers verification and placed to the immediate right of which Computer subject teachers verification was done.



The camera which was monitoring for Chemistry subject teachers verification was placed third to the right of the camera which was monitoring for Computer subject teachers verification. Neither Karan nor Hari was monitoring the person who was facing towards the south. Camera numbered 3 was monitored by Zahir and facing the opposite side to camera numbered 6. Karan and Satish were monitoring through the cameras places immediate to each other. Camera numbered 7 was placed immediate right of camera number 5 and both of them were facing different directions. Tanuj was monitoring through camera numbered 6.

एक जिले में आठ अलग-अलग विषय के शिक्षकों की भर्ती के लिए शिक्षा विभाग द्वारा एक चौकोर कमरे में दस्तावेज सत्यापन की व्यवस्था की गई थी। कमरे के दोनों ओर केंद्र की ओर मुख करके दो कुर्सियां रखी गई थीं। प्रत्येक कुर्सी पर एक व्यक्ति बैठा था जो केवल एक विषय के दस्तावेज सत्यापन कर रहा था। कमरे के बीच में कुर्सियों की ओर मुख करके आठ सीसीटीवी कैमरे लगाए गए थे यानी एक सीसीटीवी केवल एक कुर्सी पर नजर रख रहा था जहां दस्तावेज सत्यापन किया जा रहा था। प्रत्येक सीसीटीवी को 1 से 8 तक चिह्नित किया गया था। प्रत्येक सीसीटीवी की निगरानी एक व्यक्ति कर रहा था, यानी शिक्षा विभाग के आठ अलग-अलग व्यक्ति प्रक्रिया में पारदर्शिता के लिए निगरानी कर रहे थे।

प्रीत रसायन विज्ञान विषय के शिक्षकों के लिए कैमरा नंबर 4 से निगरानी कर रहा था। कैमरा नंबर 5 जो अर्थशास्त्र विषय के शिक्षकों का सत्यापन करने वाले व्यक्ति की निगरानी कर रहा था, पश्चिम की ओर मुंह करके खड़ा था। जो व्यक्ति इतिहास विषय के शिक्षक का सत्यापन कर रहा था, वह उत्तर की ओर मुंह करके खड़ा था। विज्ञान विषय के शिक्षकों के लिए सत्यापन करने वाला व्यक्ति उसी तरफ नहीं था जिस तरफ कैमरा नंबर 3 का सामना कर रहा था। मनोज सबसे अधिक नंबर वाले कैमरे से अंग्रेजी विषय के शिक्षकों के सत्यापन की निगरानी कर रहा था। जो कैमरा हिंदी विषय के शिक्षकों के सत्यापन की निगरानी कर रहा था, उसे सबसे कम नंबर वाले कैमरे के तुरंत बाईं ओर रखा गया था। कैमरा नंबर 6 और कैमरा नंबर 7 के बीच तीन कैमरे लगाए गए थे। पवन भौतिकी विषय के शिक्षकों के सत्यापन की निगरानी कर रहा था और वह कंप्यूटर विषय के शिक्षकों के सत्यापन के लिए रखे गए कैमरे के तुरंत दाईं ओर रखा गया था।



जो कैमरा रसायन विज्ञान विषय के शिक्षकों के सत्यापन की निगरानी कर रहा था, उसे कंप्यूटर विषय के शिक्षकों के सत्यापन की निगरानी करने वाले कैमरे के दाईं ओर तीसरे स्थान पर रखा गया था। न तो करण और न ही हरि उस व्यक्ति की निगरानी कर रहे थे जो दक्षिण की ओर मुंह करके खड़ा था। कैमरा नंबर 3 की निगरानी जहीर कर रहा था और वह कैमरा नंबर 6 के विपरीत दिशा में मुंह करके खड़ा था। करण और सतीश एक दूसरे के तुरंत बगल में स्थित कैमरों से निगरानी कर रहे थे। कैमरा नंबर 7 को कैमरा नंबर 5 के ठीक दाईं ओर रखा गया था और दोनों का मुंह अलग-अलग दिशाओं में था। तनुज कैमरा नंबर 6 से निगरानी कर रहा था।



ANSWER

PUZZLE 01

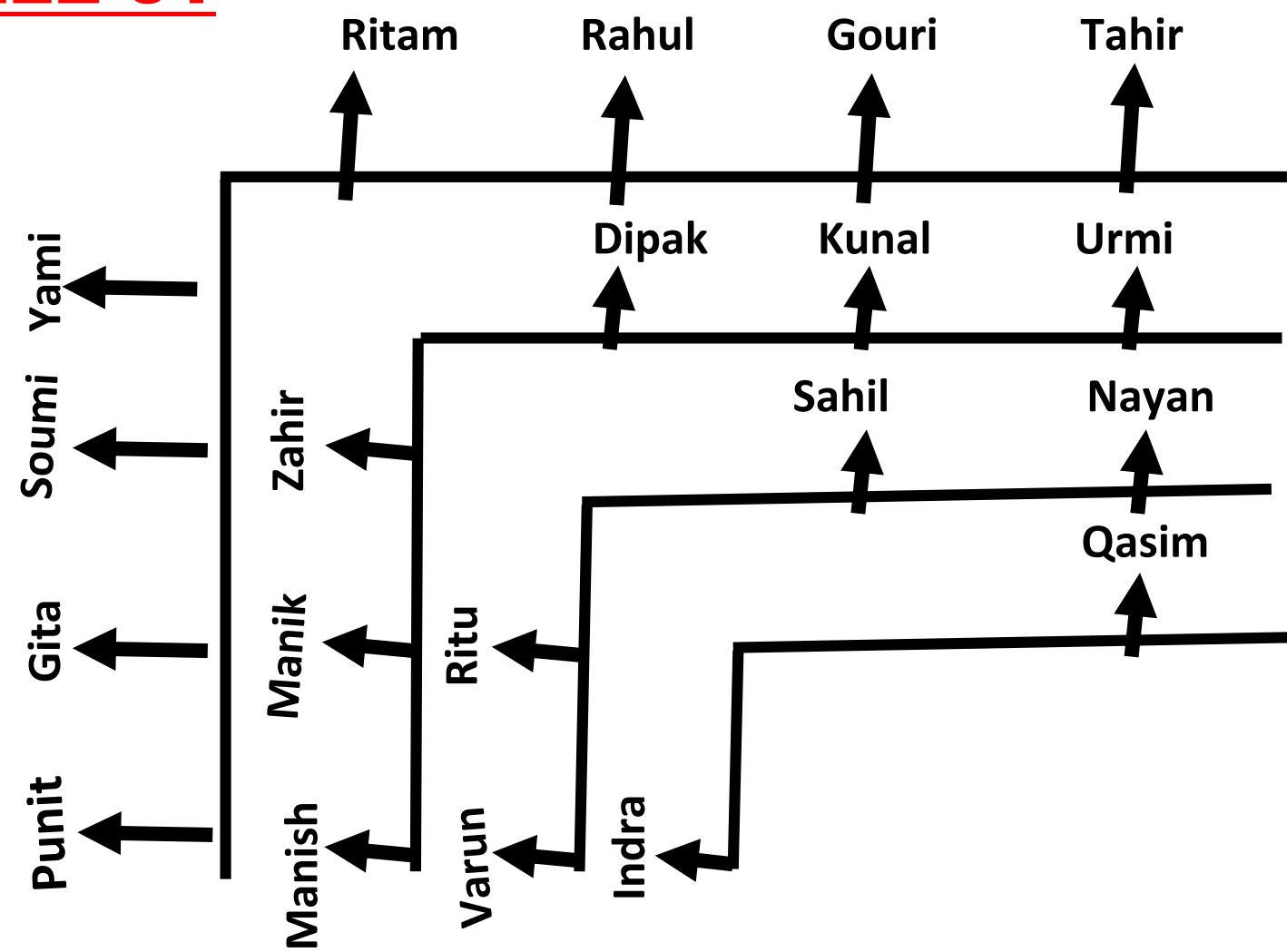

PUZZLE 02

Year	Age	Person
1949	74	Y
1962	61	C
1969	54	A
1975	48	K
1977	46	G
1980	43	T
1988	35	R
1994	29	U
2012	11	P
2015	8	H



PUZZLE 03

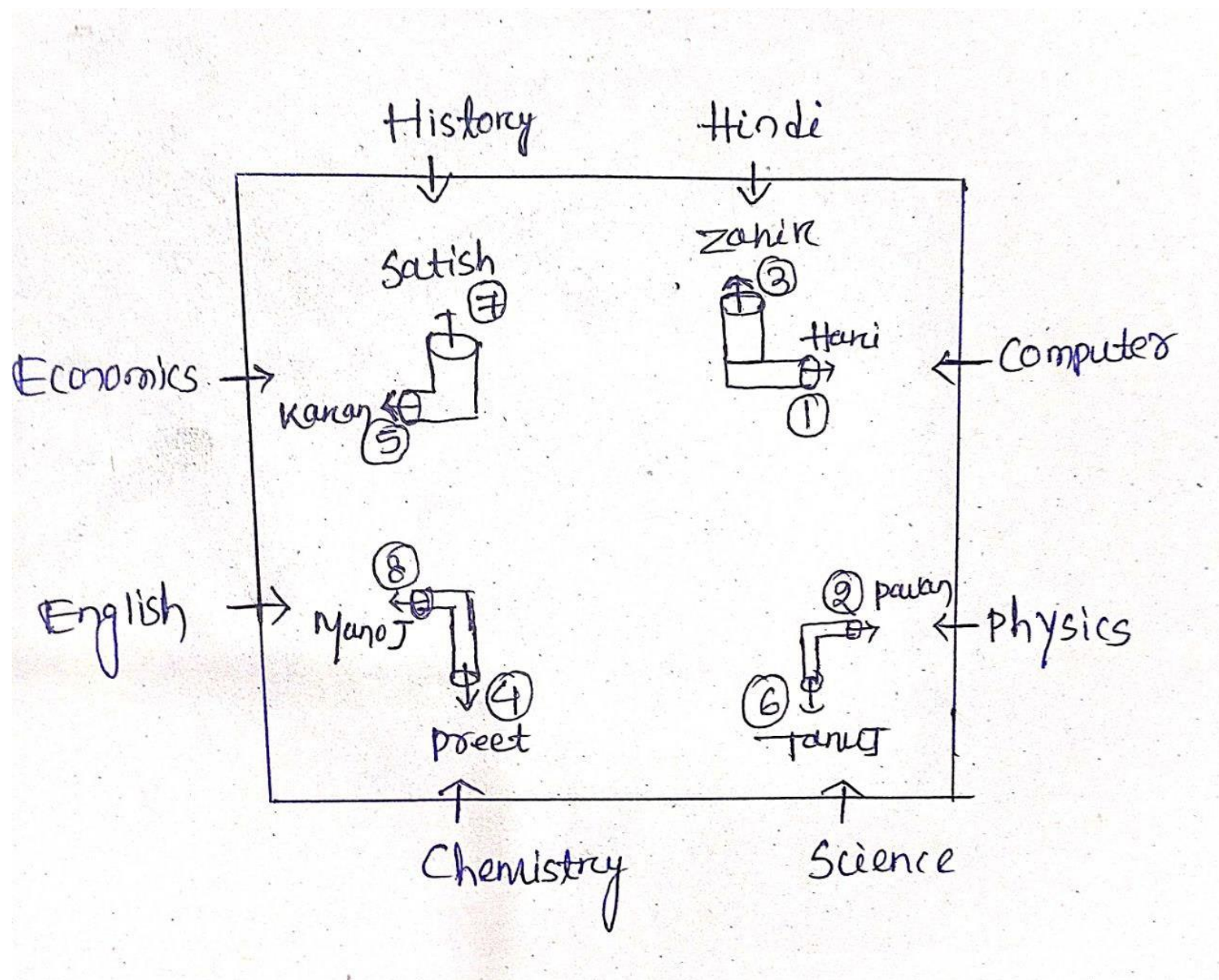

Alpha-numeric-series

S 5 @ T H 3 # 2 A % R \$ Q 6 ? M ^ B & D 7 6 * P 9 = V 4 β L α 8 X

Step 1: Two is subtracted from the numbers each of which is immediately preceded by a letter but not immediately followed by another number.

Step 2: All such letters each of which is either immediately succeeded by a symbol or immediately preceded by a number but not both are replaced by the corresponding complementary pair as per the English alphabetical series.

Step 3: All such symbols each of which is immediately succeeded by a consonant are interchanging their position with respect to the element immediately before it.

Note: Step 1 is followed by step 2 and step 2 is followed by step 3.

1. If the positions of the second odd number from the left end and the second consonant from the right end in the final step are interchanged and then the alphabets which are immediately followed by a symbol is dropped, then which of the following statement is true with respect to “^” in the final arrangement?

- a) It is 6th to the left of the =
- b) \$ is 5th to the right of ^
- c) It is 7th to the left of the 8th element from the right end
- d) It is immediately preceded as well as immediately followed by a number
- e) All the statements are true



2. What is the difference between the place values (as per the alphabetical series) of the letters which is the second vowel from the left end and the third consonant from the right end in step 2?

- a) 10
- b) 12
- c) 18
- d) 5
- e) 7

3. What is the position of the first symbol towards the left of R in Step 1?

- a) Fifth from R
- b) Second from R
- c) Fourth from R
- d) Immediate left of R
- e) Third from R

4. If every alternate element starting from @ in step 3 is dropped, then which of the following element is exactly in the middle of the third consonant from the left end and the second symbol from the right end?

- a) 6
- b) 7
- c) Y
- d) N
- e) Q



5. If every letter in step 2 is replaced by the succeeding letter (as per English alphabetical series), then how many such symbols are in the series each of which is immediately preceded by a number but not immediately followed by a vowel?

- a) Three
- b) Five
- c) Four
- d) One
- e) Two

DIRECTION SENSE

Directions (1-3): Study the following information carefully and answer the questions given below.

A@B (6) -> A is 9m to the South of B

A#B (13) -> A is 10m to the North of B

A\$B (15) -> A is 11m to the East of B

A%B (17) -> A is 27m to the west of B

Note: A#\$B means A is to the Northeast of B

Q\$Y (16), Y%U (13), U#X (19), X%N (18), N@J (23), J\$O (14), O@L (17), Y\$K (16),

K@S (14), S%H (17), H\$G (13), L#\$R

6) What is the direction of L with respect to Y?

- A. South
- B. North west
- C. North east



D. South west

E. None of these

7) Which of the following point is to the southeast of U?

A. The one which is to the east of Q

B. The one which is to the north of X

C. The one which is to the west of O

D. The one which is to the south of J

E. None of these

8) Four of the following five are alike in a certain way as per the given arrangement and hence forms a group. Find the one which doesn't belong to that group.

A. Y-L

B. G-X

C. U-O

D. Q-J

E. K-H



ANSWER

Alpha-numeric-series

Directions (1-5):

1) Answer: C

Step 3: S @ 3 T H 1 # 2 A % \$ I Q ? 4 ^ N & Y D 7 * 6 P = 7 V 2 β O α 8 C.

The Second odd number from the left end and the second consonant from the right end are 1 and V respectively.

S @ 3 T H V # 2 A % \$ I Q ? 4 ^ N & Y D 7 * 6 P = 7 1 2 β O α 8 C.

And then the alphabets which are immediately followed by a symbol is dropped .

Required series:

@ 3 T H # 2 % \$ I ? 4 ^ & Y D 7 * 6 = 7 1 2 β α 8 C.

2) Answer: E

Step 2: S 3 @ T H 1 # 2 A % I \$ Q 4 ? N ^ Y & D 7 6 * P 7 = V 2 β O α 8 C

The Second vowel from the left end is I and the third consonant from the right end is P The Place value of I is 9 and the place value of P is 16 .16-9=7

3) Answer: D

Step 1: S 3 @ T H 1 # 2 A % R \$ Q 4 ? M ^ B & D 7 6 * P 7 = V 2 β L α 8 X



4) Answer: B

Step 3: S @ 3 T H 1 # 2 A % \$ I Q ? 4 ^ N & Y D 7 * 6 P = 7 V 2 β O α 8 C.

Every alternate element starting from @ is dropped from the given series

Required series:

S 3 H # A \$ Q 4 N Y 7 6 = V β α C

S 3 H # A \$ Q 4 N Y 7 6 = V β α C

The third consonant from the left end is Q and the second symbol from the right end is β

Q 4 N Y 7 6 = V β.

5) Answer: C

Step 2: S 3 @ T H 1 # 2 A % I \$ Q 4 ? N ^ Y & D 7 6 * P 7 = V 2 β O α 8 C

Every letter is replaced by a succeeding letter as per the alphabetical series

Required series: T 3 @ U I 1 # 2 B % J \$ R 4 ? O ^ Z & E 7 6 * Q 7 = W 2 β P α 8 D

Step 1: Two is subtracted from the numbers each of which is immediately preceded by a letter but not immediately followed by another number. Given series:

S 5 @ T H 3 # 2 A % R \$ Q 6 ? M ^ B & D 7 6 * P 9 = V 4 β L α 8 X

Required series:

Step 1: S 3 @ T H 1 # 2 A % R \$ Q 4 ? M ^ B & D 7 6 * P 7 = V 2 β L α 8 X

From Step 1,



Step 2: All such letters each of which is either immediately succeeded by a symbol or immediately preceded by a number but not both are replaced with the corresponding complementary pair as per the English alphabetical series.

Step 1: S 3 @ T H 1 # 2 A % R \$ Q 4 ? M ^ B & D 7 6 * P 7 = V 2 β L α 8 X

Required series:

Step 2: S 3 @ T H 1 # 2 A % I \$ Q 4 ? N ^ Y & D 7 6 * P 7 = V 2 β O α 8 C

From Step 2, Step 3: All such symbols each of which is immediately followed by a consonant are interchanged their position with respect to the element immediately before it.

Step 2: S 3 @ T H 1 # 2 A % I \$ Q 4 ? N ^ Y & D 7 6 * P 7 = V 2 β O α 8 C

Required series: Step 3: S @ 3 T H 1 # 2 A % \$ I Q ? 4 ^ N & Y D 7 * 6 P = 7 V 2 β O α 8 C.



DIRECTION SENSE

Directions (1-3):

1) Answer: C

2) Answer: D

3) Answer: B (The first point is to the southwest of the second point, except option b)

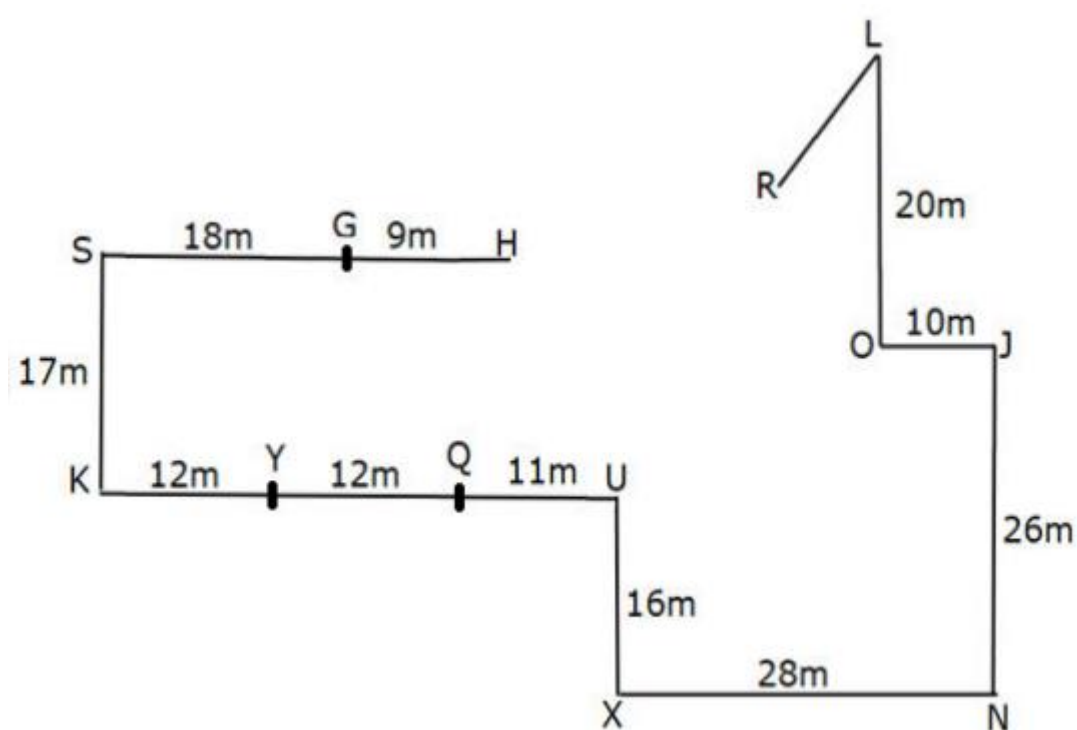

GIVE YOUR FEEDBACK IN COMMENT SECTION

